



A Sanctuary in a Garden



A Sanctuary in a Garden

God is:

- Personal
- Intimate
- Relational



A Sanctuary in a Garden

Genesis 2:7-10 ⁷ Then the LORD God formed man of dust from the ground, and breathed into his nostrils the breath of life; and man became a living being.
⁸ And the LORD God planted a garden toward the east, in Eden; and there He placed the man whom He had formed.

A Sanctuary in a Garden

⁹ And out of the ground the LORD God caused to grow every tree that is pleasing to the sight and good for food; the tree of life also in the midst of the garden, and the tree of the knowledge of good and evil. ¹⁰ Now a river flowed out of Eden to water the garden; and from there it divided and became four rivers.

- **EDEN: delight**



A Sanctuary in a Garden

PURPOSE OF MAN AND

RELATIONSHIP TO GOD

Genesis 2:15-17 ¹⁵ Then the LORD God took the man and put him into the garden of Eden to cultivate it and keep it. ¹⁶ And the LORD God commanded the man, saying, "From any tree of the garden you may eat freely; ¹⁷ but from the tree of the knowledge of good and evil you shall not eat, for in the day that you eat from it you shall surely die."



A Sanctuary in a Garden

PURPOSE OF MAN AND RELATIONSHIP TO GOD

Genesis 3:8 And they heard the sound of the LORD God walking in the garden in the cool of the day, and the man and his wife hid themselves from the presence of the LORD God among the trees of the garden.



A Sanctuary in a Garden

- The Garden of Eden was a sanctuary:
- A place of
 - Rest
 - Serving the Lord
 - Obedience to the Lord
 - Intimate fellowship
 - The presence of the Lord



A Sanctuary in a Garden

Genesis 2:15-17 ¹⁵ Then the LORD God took the man and **put** him into the garden of Eden to **cultivate** it and **keep** it.

A Sanctuary in a Garden

Genesis 2:15-17 ¹⁵ Then the LORD God took the man and **put** him into the garden of Eden to **cultivate** it and **keep** it.

- Put: to put at rest
- To cultivate: to serve
- To keep: to guard

A Sanctuary in a Garden

Genesis 2:15-17 ¹⁵ Then the LORD God took the man and **put** him into the garden of Eden to **cultivate** it and **keep** it.

- Put: to put at rest
- To cultivate: to serve
- To keep: to guard

Genesis 2:15-17 ¹⁵ Then the LORD God took the man and **put him at rest**, into the garden of Eden, to **serve** it and **guard** it.



A Sanctuary in a Garden

God's Original Intentions for us:

- **To serve the Lord**
- **Guard His Holiness**
- **Obey His word**



A Sanctuary in a Garden

A Sanctuary in a Garden

The Heavenly Temple

Psalm 11:4 ⁴ The LORD is in His holy temple; the LORD's throne is in heaven; His eyes behold, His eyelids test the sons of men.

A Sanctuary in a Garden

The Heavenly Temple

Exodus 25:40 ⁴⁰ "And see that you make *them* after the pattern for them, which was shown to you on the mountain.

- **Acts 7:44** Our ancestors had the tabernacle of testimony in the wilderness, just as God who spoke to Moses ordered him to make it according to the design he had seen.



A Sanctuary in a Garden

The Heavenly Temple

Hebrews 8:5 These serve as a copy and shadow of the heavenly things, as Moses was warned when he was about to complete the tabernacle. For He said, Be careful that you make everything according to the pattern that was shown to you on the mountain

The tabernacle in the wilderness and the temple on earth represented the unseen spiritual reality of God's holiness and sovereignty.

Tabernacle in Wilderness



Inside Solomon's Temple



Model of Herod's Temple



Dome of the Rock





View of Temple Mount



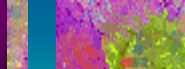



Garments of the High Priest בגדי כהן הגדול



Each Temple vessel restored by the Temple Institute is kosher for use in the soon to be rebuilt Third Temple, made according to the ex
Please donate generously to help the sacred work of the Temple Institute! Every contribution helps to

**Preparations
for the
Temple**



Model of Millennial Temple

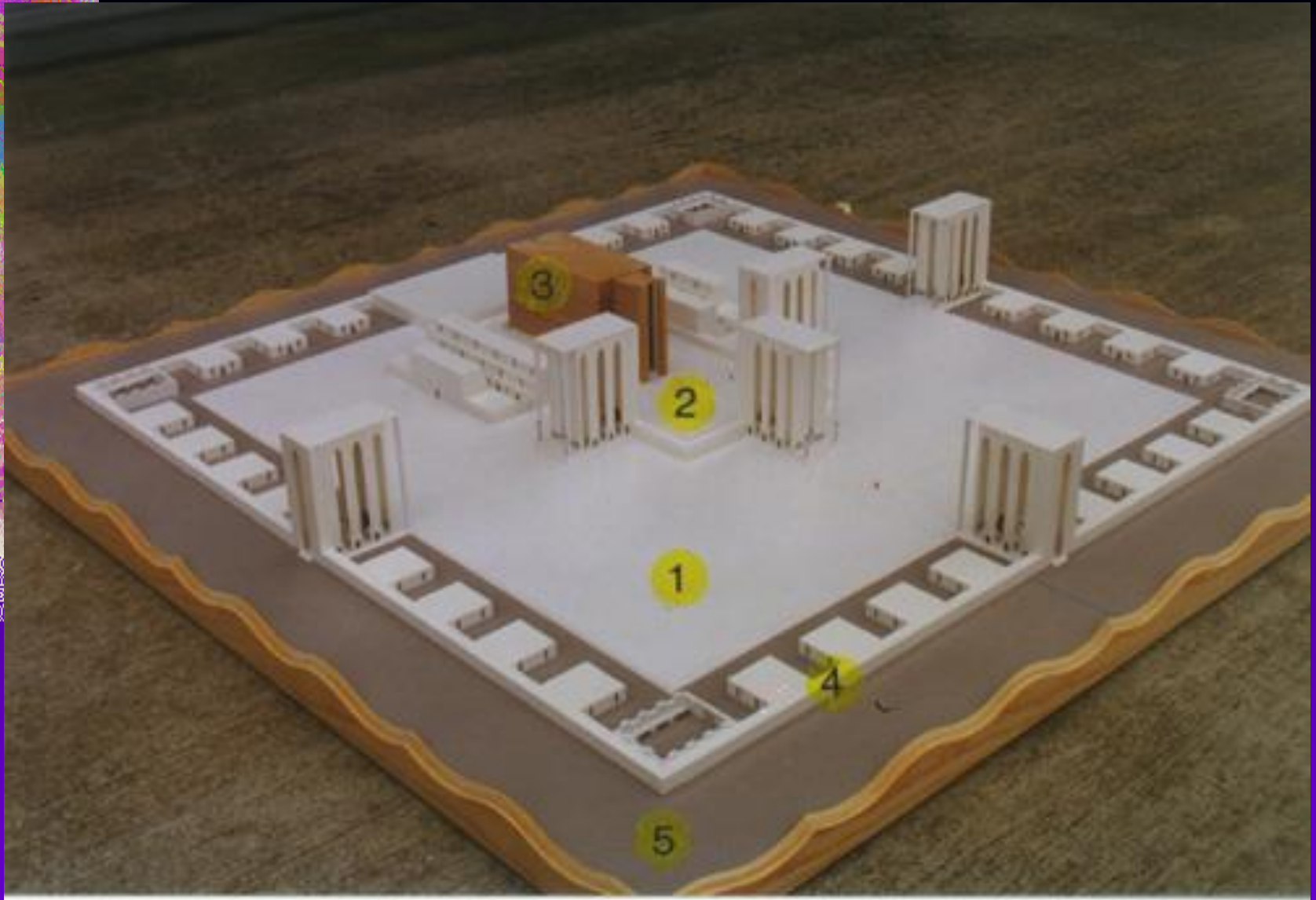

The Millennial Temple Complex

An Artist's Impression



Copyright 2004, M.J.Beattie and Andrew Beattie. Used with permission.

Fall 2020 (Volume 1 / Number 35)
אֶרֶל



ARIEL
MINISTRIES

The Nature of the
MESSIANIC KINGDOM
as Found in the Covenants

Plus:

**Translation Errors and
Flat Earth Theories**

The Inquisition in Castile

**Galatians and the
Believer's Freedom in Messiah**

How to Pray Like Daniel

Fall 2020 / Volume 1 / Number 35



ARIEL
MINISTRIES

The Nature of the MESSIANIC KINGDOM

as Found in the Covenants

Plus:

**Translation Errors and
Flat Earth Theories**

The Inquisition in Castile

**Galatians and the
Believer's Freedom in Messiah**

How to Pray Like Daniel



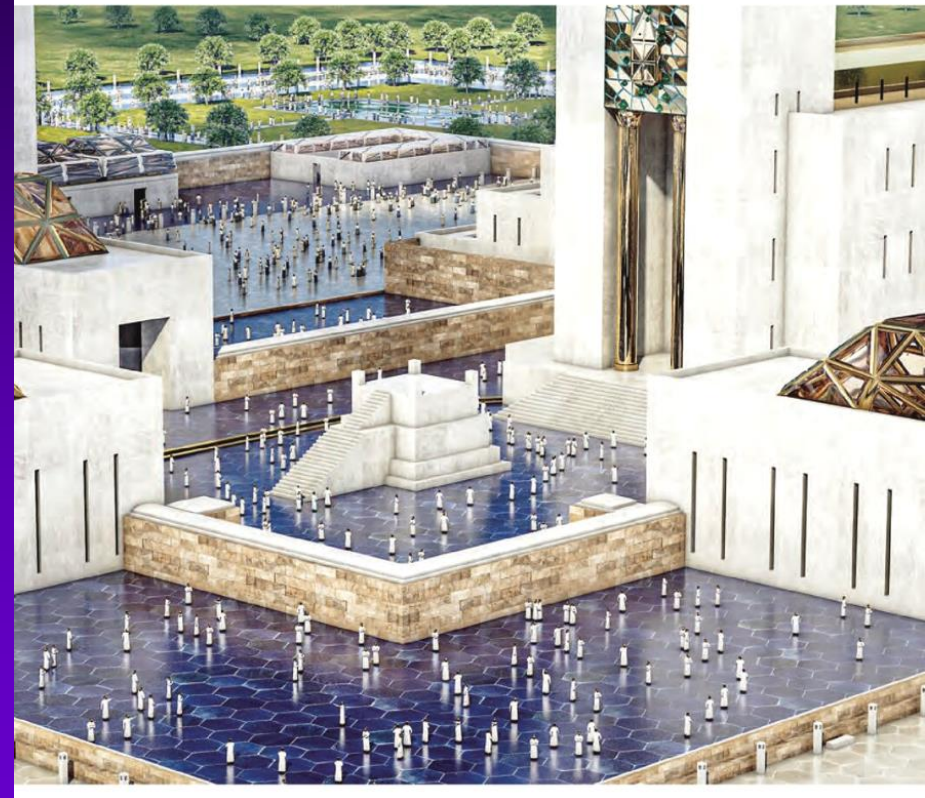
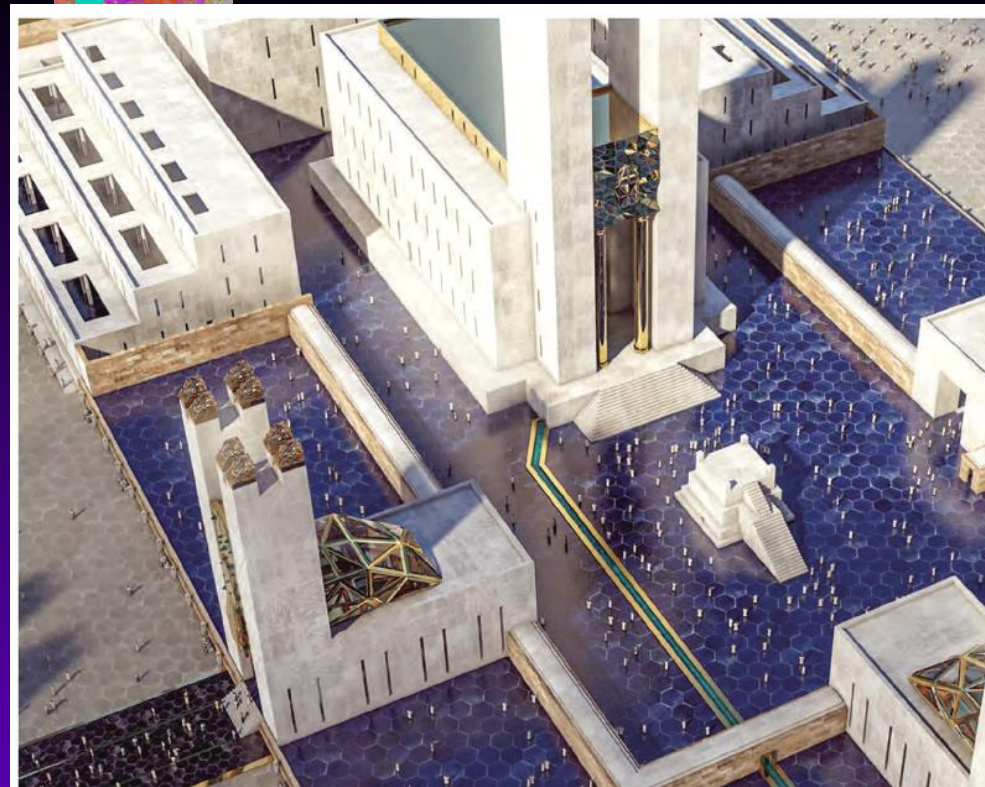



06

COVER STORY

THE NATURE OF THE COMING
MESSIANIC KINGDOM AS FOUND IN ITS COVENANTS

By Daniel Goepfrich

JERUSALEM



The purpose of this article is to explore the biblical teaching of the nature of the kingdom from the four unconditional covenants established by God. As the doctrine of the kingdom unfolds, we will discover that each of the covenants answers one of these basic questions: *why*, *where*, *whose*, and *what kind*. By accepting a literal answer to these questions, readers should arrive at the normative dispensational conclusion that the kingdom and the church are not the same. Instead, the kingdom will be Yeshua's literal, future, earthly rule from Jerusalem, Israel.

<https://www.ariel.org/magazine>



A Sanctuary in a Garden

The Millennial Temple

Five Distinct Purposes:

- 1. To Demonstrate God's Holiness**
- 2. To Provide a Dwelling-Place for the Divine Glory**
- 3. To Perpetuate the Memorial of Sacrifice**
- 4. To Provide the Center for Divine Government**
- 5. To Provide Victory over the Curse**



06

COVER STORY

THE NATURE OF THE COMING
MESSIANIC KINGDOM AS FOUND IN ITS COVENANTS

By Daniel Goepfrich

JERUSALEM



The purpose of this article is to explore the biblical teaching of the nature of the kingdom from the four unconditional covenants established by God. As the doctrine of the kingdom unfolds, we will discover that each of the covenants answers one of these basic questions: *why*, *where*, *whose*, and *what kind*. By accepting a literal answer to these questions, readers should arrive at the normative dispensational conclusion that the kingdom and the church are not the same. Instead, the kingdom will be Yeshua's literal, future, earthly rule from Jerusalem, Israel.

<https://www.ariel.org/magazine>